



GrandOver & Above

Grandover Resort

Post COVID-19 Meeting Capacities

800-472-6301
www.grandover.com

BANQUET ROOM	DIMENSIONS	SQ FT	CEILING HEIGHT	CLASSROOM		THEATRE		HALF ROUNDS		USHAPE		BANQUET - OVALS		RECEPTION - Standing	
				Standard	Modified	Standard	Modified	Standard	Modified	Standard	Modified	Standard	Modified	Standard	Modified
Carlisle	75x57	4275	12'-15'	200	80	400	125	190	60	50	24	280	90	300	125
Grandville	130x100	13,000	16'-18'	900	200	1200	450	550	160	NA	NA	900	240	1000	350
Grandville - 1/4	65x50	3250	16'-18'	150	48	250	100	84	32	45	22	120	54	250	125
Grandville - 1/2	65x100	6500	16'-18'	350	100	600	150	280	80	70	35	350	120	400	250
Grandview	86x51	4386	12'-14'	130	50	250	80	175	56	NA	NA	250	90	300	150
Grandview A or B	43x51 each	2193 ea	12'-14'	60	24	125	40	84	24	35	16	120	36	150	60
Griffin	92x38	3496	40'	NA	NA	NA	NA	NA	NA	NA	NA	250	96	300	125
Griffin B	52x38	1976	40'	90	36	180	60	98	36	45	22	140	54	200	85
Griffin A	40x38	1520	40'	70	24	130	40	70	20	35	16	100	42	100	40
Whitehall	-	-	12'	87	30	NA	NA	NA	NA	NA	NA	NA	NA	NA	NA
Lawn	65x115	7475	-	NA	NA	700	200	NA	NA	NA	NA	400	160	500	200
Grassy Knoll				NA	NA	100	30	NA	NA	NA	NA	70	32	100	25
Beaumont	41x25	1025	12'	50	20	80	25	40	20	30	15	70	30	75	25
Berkeley	41x25	1025	12'	50	20	80	25	40	20	30	15	70	30	75	25
Clermont	30x24	720	12'	25	10	60	20	20	12	20	10	50	18	50	15
Hamilton	21x21	441	10'	12	6	25	8	NA	NA	10	5	20	6	NA	12
Montgomery	27x20	540	12'	20	8	40	12	20	8	14	7	30	6	NA	12
Nottingham	55x37	2035	11'-13'	70	32	120	40	60	24	30	15	120	36	125	50
Provincial	40x28	1120	12'	40	16	80	25	40	16	25	12	70	30	80	30
Renoir	31x26	806	12'	30	15	60	20	30	12	20	10	50	24	60	25
Riveria	33x27	891	12'	35	15	70	20	30	16	22	10	50	24	70	25
Savoy	42x24	1008	10'	40	20	80	25	40	16	22	10	70	30	70	25
Trinity	30x29	870	12'	30	12	70	20	30	12	18	9	50	24	50	20
Wentworth	28x24	672	10'	20	12	50	15	20	12	15	7	40	18	40	12
Windsor	28x27	756	12'	20	8	50	15	30	16	15	7	50	24	50	15
PERMANENT BOARDROOMS:				CONFERENCE SET											
Baroque Boardroom	-	-	10'	8	4										
Carlton Boardroom	21x17	357	11'	12	6										
Kingsley Boardroom	21x21	441	10'	10	5										
Regents Boardroom	28x18	504	10'	16	8										
			STANDARD SETS:					MODIFIED SETS:							
			Classroom - 4 people per 8ft table					Classroom - 2 people per 8ft table							
			Theatre - chairs with no spacing					Theatre - chairs with 2 chair spacing							
			Half Rounds - 7 people per oval					Half Rounds - 4 people per oval							
			Ushape - 4 people per 8ft table					Ushape - 2 people per 8ft table							
			Banquet Ovals - 10 people per oval					Banquet Ovals - 6 people per oval							



Banquet & Meeting Rooms

Capacity numbers calculated without dance floor, head table, extensive audiovisual, etc.

RESORT & CONFERENCE CENTER GOLF-SPA

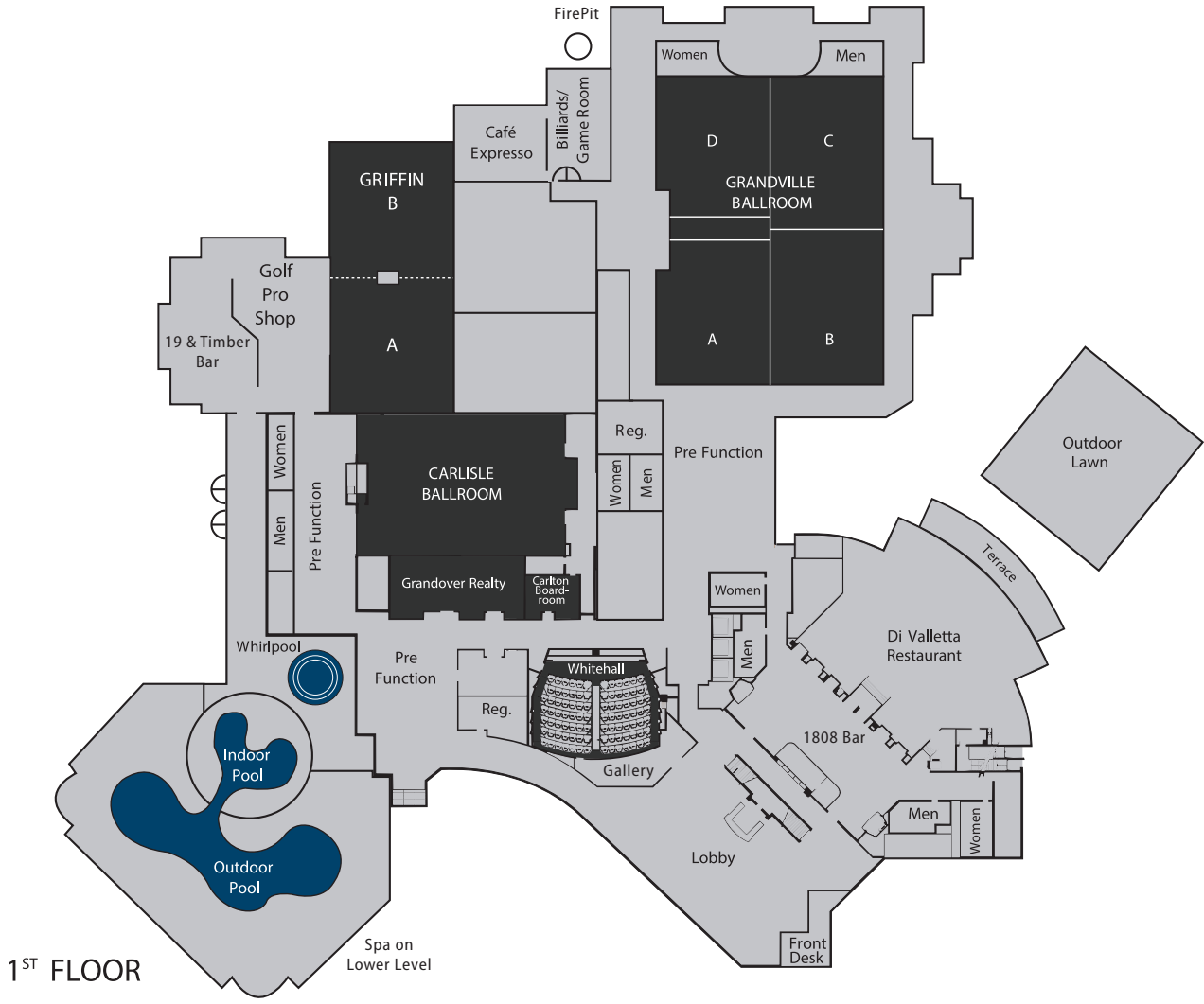

	Square Feet	Dimensions	Ceiling Height	Seating Capacity				
				Banquet	Reception	Classroom	Theatre	U-Shape
Grandville Ballroom	13,000	130x100	16'-18'	1000	1350	950	1400	164
Grandville A or D	2950	59x50	16'-18'	200	300	200	300	68
Grandville B or C	3250	65x50	16'-18'	240	330	220	350	68
Carlisle Ballroom	4275	75x57	12'-15'	300	400	230	440	88
Carlisle Foyer	1900	-	14'	-	200	-	-	-
Carlton Boardroom	357	21x17	11'	12	-	-	-	-
Whitehall Theatre	-	-	12'	-	-	85	-	-
Griffin	3496	92x38	40'	260	350	-	-	-
Griffin A	1520	40x38	40'	120	150	90	160	36
Griffin B	1976	52x38	40'	140	200	110	200	52
Outdoor Lawn	7475	65x115	-	500	1000	-	-	-



Banquet & Meeting Rooms

Capacity numbers calculated without dance floor, head table, extensive audiovisual, etc.

RESORT & CONFERENCE CENTER GOLF-SPA

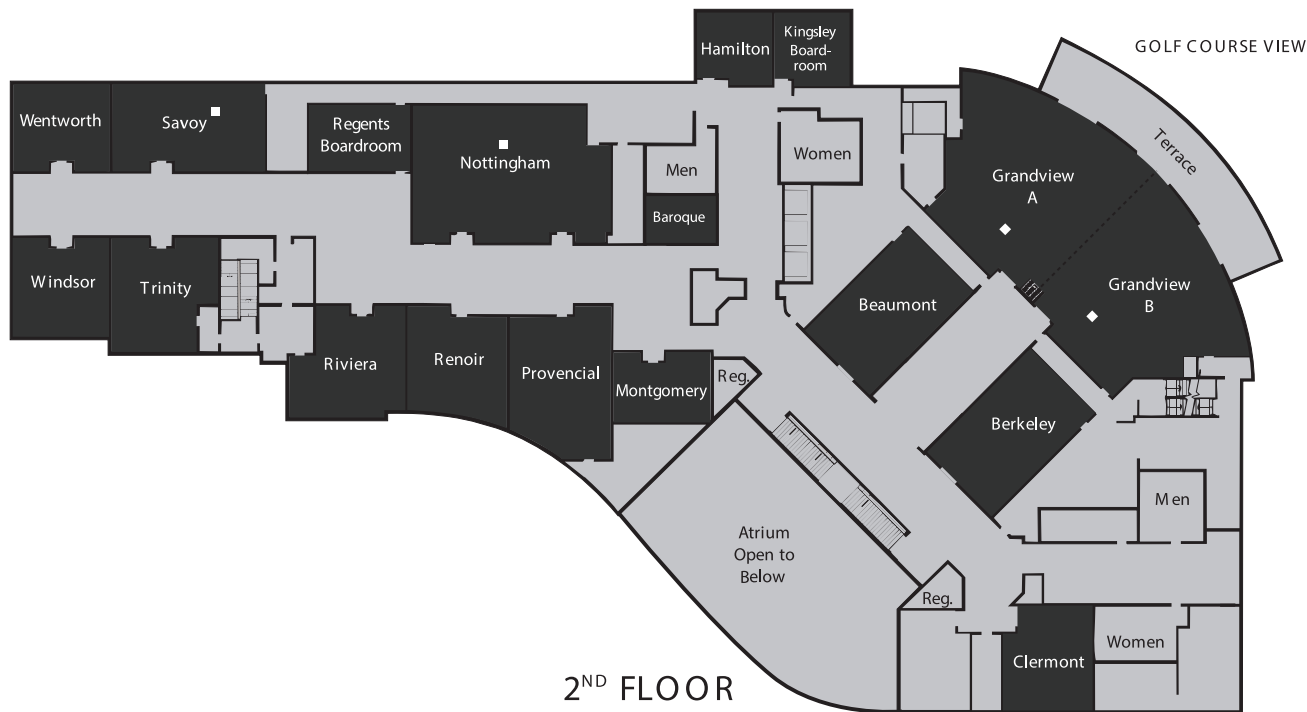

2ND FLOOR

	Square Feet	Dimensions	Ceiling Height	Seating Capacity				
				Banquet	Reception	Classroom	Theatre	U-Shape
Grandview	4386	86x51	12'-14'	280	400	160	300	-
Grandview A	2193	43x51	12'-14'	120	180	70	130	40
Grandview B	2193	43x51	12'-14'	120	180	70	130	36
Beaumont	1025	41x25	12'	70	80	60	100	32
Berkeley	1025	41x25	12'	70	80	60	100	32
Clermont	720	30x24	12'	50	60	32	70	24
Montgomery	540	27x20	12'	30	40	24	50	16
Provencial	1120	40x28	12'	70	90	48	100	28
Renoir	806	31x26	12'	50	70	36	70	24
Riviera	891	33x27	12'	50	80	40	80	24
Trinity	870	30x29	12'	50	60	36	80	20
Windsor	756	28x27	12'	50	60	24	60	20
Wentworth	672	28x24	10'	40	60	24	55	18
Savoy	1008	42x24	10'	70	90	48	90	26
Nottingham	2035	55x37	11'-13'	120	150	80	150	44
Hamilton	441	21x21	10'	20	25	16	30	12
Regents Boardroom	504	28x18	10'	16	-	N/A	-	-
Kingsley Boardroom	441	21x21	10'	10	-	N/A	-	-
Baroque Boardroom	-	-	10'	8	-	N/A	-	-